



# The GLEN at *Sand Creek*

## FLOOR PLANS

The Glen at Sand Creek offer abundant living space and intelligent 2-3 bedroom designs.

Eating nooks in the kitchen, spacious bedrooms with roomy closets, 2.5 bathrooms, bonus rooms and attached two car garage.

Built with a rustic contemporary flair that blends stucco, metal and cement siding into this scenic Colorado setting.

The community maintains everything outside including snow removal to your door and trash service.

Situated between Powers Blvd. and Academy Blvd., makes you minutes from everything in town:

- ▶ 10 minutes to downtown
- ▶ 5 minutes to Powers shopping
- ▶ 7 minutes to the Citadel Mall
- ▶ 2 Minutes to Peterson AFB
- ▶ 12 minutes to Fort Carson

## *Aspen* -2BEDROOM, 1400SF, FRONT ENTRANCE



### ROOM SIZES

- FAMILY ROOM 15'X16'
- KITCHEN 6'X14'
- BONUS ROOM 12.5'X13'
- MASTER BEDROOM 13'X16'
- 2ND BEDROOM 14'X10'
- GARAGE 19'X19'

### INTERIOR FEATURES

- Air Conditioning
- 1" Faux Wood Blinds
- Forced Air, Gas Heat
- Bonus Room
- Living Room
- Breakfast Nook
- Dishwasher
- Disposal
- Microwave
- Pantry
- Refrigerator
- Carpet
- Ceramic Tile Flooring in Kitchen, Bathrooms, Laundry
- Laundry Hook-ups on Upper Level. (No machines provided.)

### EXTERIOR FEATURES

- Trash service included
- Snow removal to your front door
- 2 Car Garage
- Walking trail at Sand Creek
- Views of Pikes Peak
- New Community
- Expansive Community lawns
- Pets Welcome

**MAINTENANCE  
FREE LIVING!**



©2013 ALL RIGHTS RESERVED



# The GLEN at Sand Creek

## FLOOR PLANS

The Glen at Sand Creek offer abundant living space and intelligent 2-3 bedroom designs.

Eating nooks in the kitchen, spacious bedrooms with roomy closets, 2.5 bathrooms, bonus rooms and attached two car garage.

Built with a rustic contemporary flair that blends stucco, metal and cement siding into this scenic Colorado setting.

The community maintains everything outside including snow removal to your door and trash service.

Situated between Powers Blvd. and Academy Blvd., makes you minutes from everything in town:

- ▶ 10 minutes to downtown
- ▶ 5 minutes to Powers shopping
- ▶ 7 minutes to the Citadel Mall
- ▶ 2 Minutes to Peterson AFB
- ▶ 12 minutes to Fort Carson

## Aspen - 3BEDROOM, 1400SF, FRONT ENTRANCE



### ROOM SIZES

- FAMILY ROOM. 15'X16'
- KITCHEN 6'X14'
- BONUS ROOM 10.5'X12'
- MASTER BEDROOM 14'X10'
- 2ND BEDROOM 12'X9.5"
- 3RD BEDROOM 12'X9.5'
- GARAGE 19'X19'

### INTERIOR FEATURES

- Air Conditioning
- 1" Faux Wood Blinds
- Forced Air, Gas Heat
- Bonus Room
- Living Room
- Breakfast Nook
- Dishwasher
- Disposal
- Microwave
- Pantry
- Refrigerator
- Carpet
- Ceramic Tile Flooring in Kitchen, Bathrooms, Laundry
- Laundry Hook-ups on Upper Level. (No machines provided.)

### EXTERIOR FEATURES

- Trash service included
- Snow removal to your front door
- 2 Car Garage
- Walking trail at Sand Creek
- Views of Pikes Peak
- New Community
- Expansive Community lawns
- Pets Welcome

**MAINTENANCE  
FREE LIVING!**



©2013 ALL RIGHTS RESERVED



# The GLEN at Sand Creek

## FLOOR PLANS

The Glen at Sand Creek offer abundant living space and intelligent 2-3 bedroom designs.

Eating nooks in the kitchen, spacious bedrooms with roomy closets, 2.5 bathrooms, bonus rooms and attached two car garage.

Built with a rustic contemporary flair that blends stucco, metal and cement siding into this scenic Colorado setting.

The community maintains everything outside including snow removal to your door and trash service.

Situated between Powers Blvd. and Academy Blvd., makes you minutes from everything in town:

- ▶ 10 minutes to downtown
- ▶ 5 minutes to Powers shopping
- ▶ 7 minutes to the Citadel Mall
- ▶ 2 Minutes to Peterson AFB
- ▶ 12 minutes to Fort Carson

### *Spruce* - 2BEDROOM, 1400SF, SIDE ENTRANCE

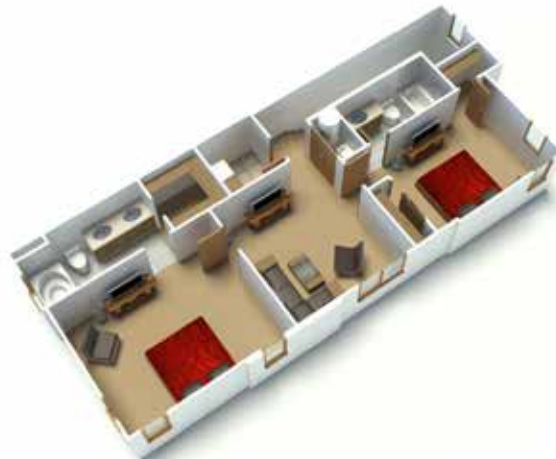

#### ROOM SIZES

- FAMILY ROOM 16'X12'
- KITCHEN 6.5'X14'
- DINE NOOK 10'X8'
- BONUS ROOM 12.5'X13'
- MASTER BEDROOM 13'X16'
- 2ND BEDROOM 14'X10'
- GARAGE 19'X19'

#### INTERIOR FEATURES

- Air Conditioning
- 1" Faux Wood Blinds
- Forced Air, Gas Heat
- Bonus Room
- Living Room
- Breakfast Nook
- Dishwasher
- Disposal
- Microwave
- Pantry
- Refrigerator
- Carpet
- Ceramic Tile Flooring in Kitchen, Bathrooms, Laundry
- Laundry Hook-ups on Upper Level. (No machines provided.)

#### EXTERIOR FEATURES

- Trash service included
- Snow removal to your front door
- 2 Car Garage
- Walking trail at Sand Creek
- Views of Pikes Peak
- New Community
- Expansive Community lawns
- Pets Welcome

**MAINTENANCE  
FREE LIVING!**



©2013 ALL RIGHTS RESERVED



# The GLEN at Sand Creek

## FLOOR PLANS

The Glen at Sand Creek offers abundant living space and well thought out 2-3 bedroom design. Eating nooks in the kitchen, spacious bedrooms with roomy closets, 2.5 bathrooms, bonus rooms and attached two car garage.

Built with a rustic contemporary flair that blends stucco, metal and cement siding into this scenic Colorado setting.

The community maintains everything outside including snow removal to your door and trash service.

Situated between Powers Blvd. and Academy Blvd., makes you minutes from everything in town:

- ▶ 10 minutes to downtown
- ▶ 5 minutes to Powers shopping
- ▶ 7 minutes to the Citadel Mall
- ▶ 2 Minutes to Peterson AFB
- ▶ 12 minutes to Fort Carson

### *Spruce* - 3BEDROOM, 1400SF, SIDE ENTRANCE



#### ROOM SIZES

- FAMILY ROOM. 16'X12'
- KITCHEN 6.5'X14'
- DINE NOOK 10'X8'
- BONUS ROOM 10.5'X12'
- MASTER BEDROOM 14'X10'
- 2ND BEDROOM 12'X9.5"
- 3RD BEDROOM 12'X9.5'
- GARAGE 19'X19'

#### INTERIOR FEATURES

- Air Conditioning
- 1" Faux Wood Blinds
- Forced Air, Gas Heat
- Bonus Room
- Living Room
- Breakfast Nook
- Dishwasher
- Disposal
- Microwave
- Pantry
- Refrigerator
- Carpet
- Ceramic Tile Flooring in Kitchen, Bathrooms, Laundry
- Laundry Hook-ups on Upper Level. (No machines provided.)

#### EXTERIOR FEATURES

- Trash service included
- Snow removal to your front door
- 2 Car Garage
- Walking trail at Sand Creek
- Views of Pikes Peak
- New Community
- Expansive Community lawns
- Pets Welcome

**MAINTENANCE  
FREE LIVING!**



©2013 ALL RIGHTS RESERVED



# The GLEN at Sand Creek

## FLOOR PLANS

The Glen at Sand Creek offers generous living space and an efficient creative 2-3 bedroom design. Eating nooks in the kitchen, spacious bedrooms with roomy closets, 2.5 bathrooms, bonus rooms and attached two car garage.

Built with a rustic contemporary flair that blends stucco, metal and cement siding into this scenic Colorado setting.

The community maintains everything outside including snow removal to your door and trash service.

Situated between Powers Blvd. and Academy Blvd., makes you minutes from everything in town:

- ▶ 10 minutes to downtown
- ▶ 5 minutes to Powers shopping
- ▶ 7 minutes to the Citadel Mall
- ▶ 2 Minutes to Peterson AFB
- ▶ 12 minutes to Fort Carson

## Mahogany GL-3BEDROOM, 1800SF



### ROOM SIZES

MASTER BEDROOM 14.5'X11.5'  
 SECOND BEDROOM 12'X11.5'  
 THIRD BEDROOM 11.5'X11.5'  
 BONUS 14.5'X12'  
 KITCHEN 17.5'X11'  
 FAMILY ROOM: 19.5'X14'  
 ATTACHED GARAGE - 2 CAR(S)

### INTERIOR FEATURES

- Air Conditioning
- 1" Faux Wood Blinds
- Forced Air, Gas Heat
- Bonus Room
- Living Room
- Breakfast Nook
- Dishwasher
- Disposal
- Microwave
- Pantry
- Refrigerator
- Carpet
- Ceramic Tile Flooring in Kitchen, Bathrooms, Laundry
- Laundry Hook-ups on Upper Level. (No machines provided.)

### EXTERIOR FEATURES

- Trash service included
- Snow removal to your front door
- 2 Car Garage
- Walking trail at Sand Creek
- Views of Pikes Peak
- New Community
- Expansive Community lawns
- Pets Welcome

**MAINTENANCE  
 FREE LIVING!**



©2013 ALL RIGHTS RESERVED



# The GLEN at Sand Creek

## FLOOR PLANS

The Glen at Sand Creek offers abundant living space and intelligent 2-3 bedroom designs.

Eating nooks in the kitchen, spacious bedrooms with roomy closets, 2.5 bathrooms, bonus rooms and attached two car garage.

Built with a rustic contemporary flair that blends stucco, metal and cement siding into this scenic Colorado setting.

The community maintains everything outside including snow removal to your door and trash service.

Situated between Powers Blvd. and Academy Blvd., makes you minutes from everything in town:

- ▶ 10 minutes to downtown
- ▶ 5 minutes to Powers shopping
- ▶ 7 minutes to the Citadel Mall
- ▶ 2 Minutes to Peterson AFB
- ▶ 12 minutes to Fort Carson

## Mahogany GR - 3BEDROOM, 1800SF



### ROOM SIZES

MASTER BEDROOM 13.5'X11.5'  
 SECOND BEDROOM 11.5'X11.5'  
 THIRD BEDROOM 11.5'X11.5'  
 BONUS 13'X13.5'  
 KITCHEN 17.5'X11'  
 FAMILY ROOM 19'X14'  
 LAUNDRY 5'X8'  
 ATTACHED GARAGE - 2 CAR(S)

### INTERIOR FEATURES

- Air Conditioning
- 1" Faux Wood Blinds
- Forced Air, Gas Heat
- Bonus Room
- Living Room
- Breakfast Nook
- Dishwasher
- Disposal
- Microwave
- Pantry
- Refrigerator
- Carpet
- Ceramic Tile Flooring in Kitchen, Bathrooms, Laundry
- Laundry Hook-ups on Upper Level. (No machines provided.)

### EXTERIOR FEATURES

- Trash service included
- Snow removal to your front door
- 2 Car Garage
- Walking trail at Sand Creek
- Views of Pikes Peak
- New Community
- Expansive Community lawns
- Pets Welcome

**MAINTENANCE  
FREE LIVING!**



©2013 ALL RIGHTS RESERVED